

卫生级安全阀/旋塞阀/角座阀系列
Sanitary Safety Valve/Plug Valve/Angle Valve Series

安全阀(溢流阀) Safety valve(Relief valve)
| 2080001

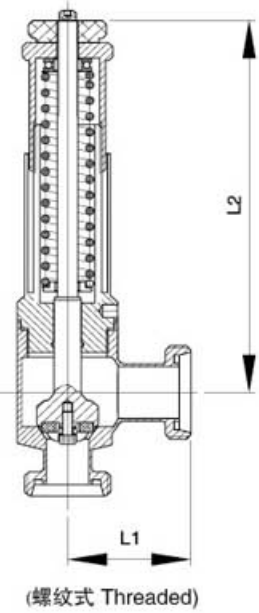

Size	L2	L1			kg
		焊接式	螺纹式	卡箍式	
25	210.0	60.0	40.0	60.0	
32	220.0	60.0	40.0	60.0	
40	230.0	70.0	50.0	70.0	
50	240.0	80.0	60.0	80.0	

阀体组合 Valve body combination

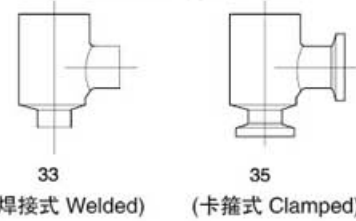

旋塞阀 Four-way plug valve
| 2091002

接口方式有: 二通、三通、四通, 螺纹式、焊接式、卡箍式
Connection type: Two-way, Three-way, Four-way, Threaded, Welded, Clamped

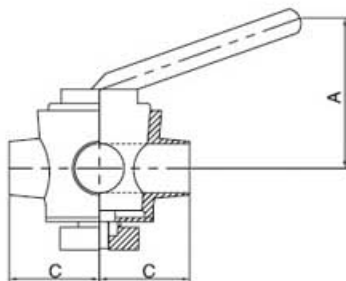

Size	A	C	kg
1"	96.0	55.0	
1 1/2"	110.0	70.0	
2"	122.0	85.0	
2 1/2"	128.0	105.0	

气动角座阀 Pneumatic angle valve
| 2103003

接口方式有: 螺纹式、焊接式、卡箍式
Connection type: Threaded, Welded, Clamped

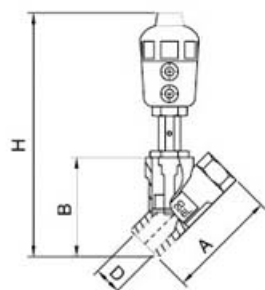

Size	A	B	H	D	kg
1/2"	85.0	75.0	215.0	1/2"	
3/4"	95.0	85.0	227.0	3/4"	
1"	105.0	95.0	255.0	1"	
1 1/4"	120.0	110.0	285.0	1 1/4"	
1 1/2"	130.0	120.0	31.0	1 1/2"	
2"	150.0	140.0	340.0	2"	
2 1/2"	185.0	175.0	375.0	2 1/2"	

卫生级换向阀系列
Sanitary Reversing Valve Series

气动截止换向阀 Pneumatic reversing valve
| DIN | 2111004

接口方式有: 螺纹式 焊接式 卡箍式
Connection type: Threaded, welded, clamped

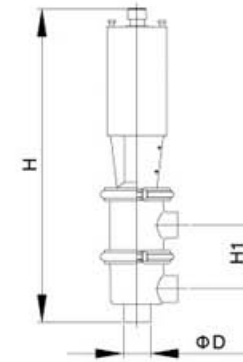

Size	D	H	H1	kg
1 1/2"	40.0	414.0	79.0	
2"	52.0	448.0	94.0	
2 1/2"	70.0	497.0	113.0	

手动截止换向阀 Manual reversing valve
| DIN | 2111005

接口方式有: 螺纹式 焊接式 卡箍式
Connection type: Threaded, welded, clamped

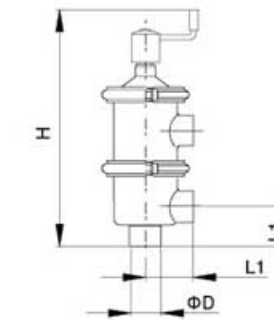

Size	D	H	L1	kg
1 1/2"	40.0	326.0	79.0	
2"	52.0	326.0	94.0	
2 1/2"	70.0	391.0	113.0	

阀体组合 Valve body combination
| DIN | 2111006

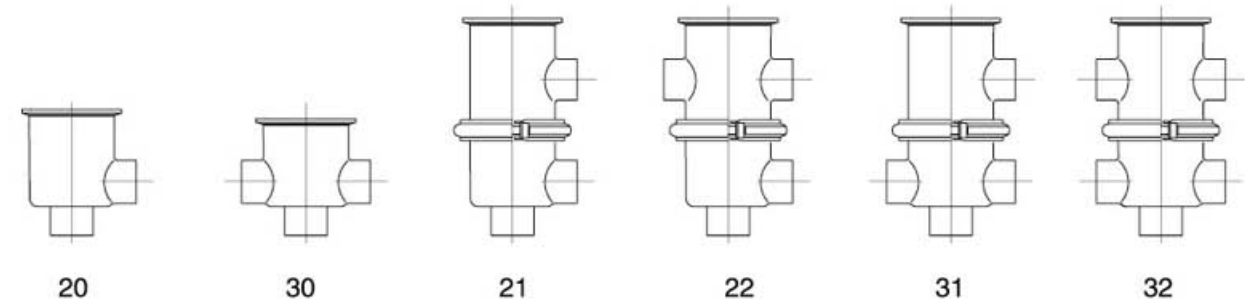

卫生级采样阀系列
Sanitary Sample Valve Series

螺纹式采样阀 Threaded sample valve
2123001

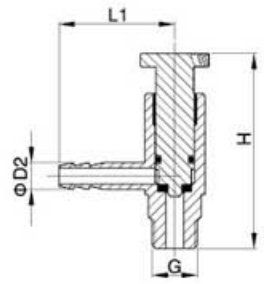

Size	H	D2	G	L1	kg
1/2"	89	12	1/2"	52	
3/4"	89	12	3/4"	52	

卫生级采样阀系列
Sanitary Sample Valve Series

焊接式采样阀 Welded sample valve
2121004

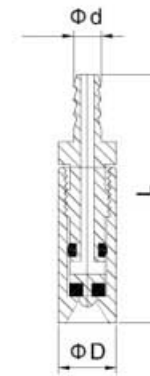

Size	L	D	d	Kg
1/2"	57.0	12.7	6.0	

卡箍式采样阀 Clamped sample valve
2122002

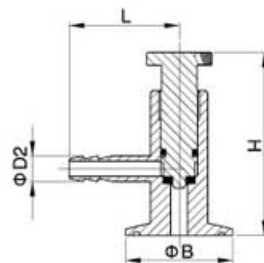

Size	H	D2	B	L1	kg
1/2"	89	12	50.5	52	

卫生级无菌采样阀 Sanitary sterile sample valve
2123005

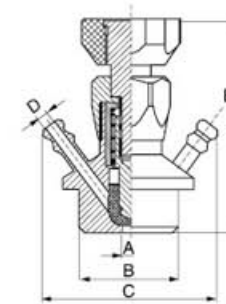

Size	A	B	C	D	E	Kg
DN15	6	57	75	4	75	
DN25	8	74	92	8	98	

焊接式采样阀 Welded sample valve
2121003

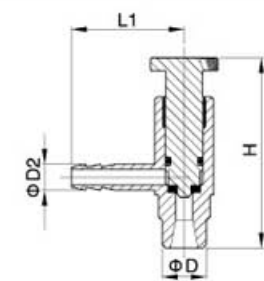

Size	H	D2	D	L1	kg
1/2"	89	12	25.4	52	