

卫生级过滤器系列
Sanitary Strainer Series

焊接式直通过滤器 Welded straight strainer
| DIN | 3131001

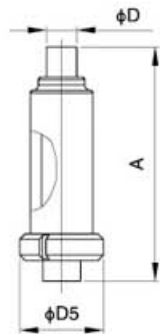

Size	A	D	D5			kg
DN25	306.0	28.0	95.0			
DN32	306.0	34.0	110.0			
DN40	306.0	40.0	110.0			
DN50	406.0	52.0	110.0			
DN65	503.0	70.0	127.0			
DN80	561.0	85.0	148.0			
DN100	662.0	104.0	178.0			

卡箍式直通过滤器 Clamped straight strainer
| DIN | 3132002

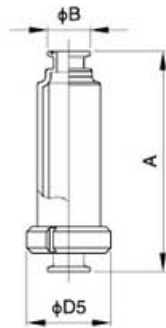

Size	A	B	D5			kg
DN25	306.0	50.5	95.0			
DN32	306.0	50.5	110.0			
DN40	306.0	50.5	110.0			
DN50	406.0	64.0	110.0			
DN65	503.0	77.5	127.0			
DN80	561.0	91.0	148.0			
DN100	662.0	119.0	178.0			

焊接角式过滤器 Welded angle-type strainer
| DIN | 3131003

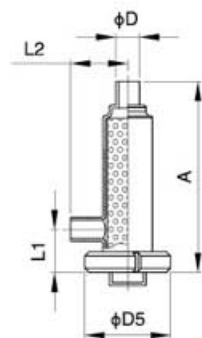

Size	A	D	D5	L1	L2	kg
DN25	306.0	28.0	95.0	60.0	70.0	
DN32	306.0	34.0	110.0	60.0	70.0	
DN40	306.0	40.0	110.0	80.0	70.0	
DN50	406.0	52.0	110.0	100.0	72.0	
DN65	503.0	70.0	127.0	120.0	85.0	
DN80	561.0	85.0	148.0	140.0	96.0	
DN100	662.0	104.0	178.0	160.0	117.0	

卫生级过滤器系列
Sanitary Strainer Series

螺纹角式过滤器 Threaded angle-type strainer
| DIN | 3133004

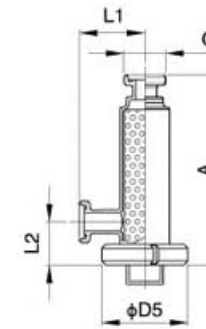

Size	A	G	D5	L1	L2	kg
DN25	306.0	RD52 x 1/6	95.0	60.0	70.0	
DN32	306.0	RD58 x 1/6	110.0	60.0	70.0	
DN40	306.0	RD65 x 1/6	110.0	80.0	70.0	
DN50	406.0	RD78 x 1/6	110.0	100.0	72.0	
DN65	503.0	RD95 x 1/6	127.0	120.0	85.0	
DN80	561.0	RD110 x 1/4	148.0	140.0	96.0	
DN100	662.0	RD130 x 1/4	178.0	160.0	117.0	

螺纹式Y型过滤器 Threaded Y-type strainer
| DIN | 3133005

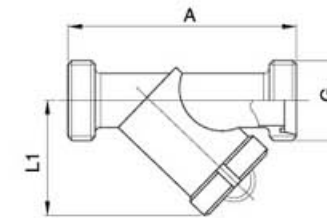

Size	A	L1	G			kg
DN25	125.0	95.0	RD52 x 1/6			
DN32	140.0	104.0	RD58 x 1/6			
DN40	165.0	110.0	RD65 x 1/6			
DN50	195.0	140.0	RD78 x 1/6			
DN65	230.0	185.0	RD95 x 1/6			
DN80	280.0	220.0	RD110 x 1/4			
DN100	340.0	248.0	RD130 x 1/4			

焊接式Y型过滤器 Welded Y-type strainer
| DIN | 3131006

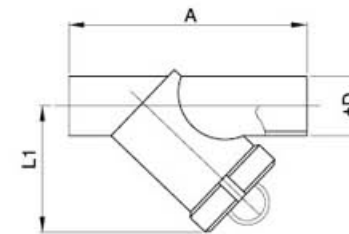

Size	A	D	L1			kg
DN25	125.0	28.0	95.0			
DN32	140.0	34.0	104.0			
DN40	165.0	40.0	110.0			
DN50	195.0	52.0	140.0			
DN65	230.0	70.0	185.0			
DN80	280.0	85.0	220.0			
DN100	340.0	104.0	248.0			

卫生级过滤器系列
Sanitary Strainer Series

焊接式直通过滤器 Welded straight strainer
|SMS|3A|IDF|ISO|3131007

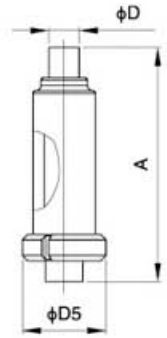

Size	A	D	D5	kg
1"	25	306.0	25.4	95.0
1 1/4"	32	306.0	32.0	110.0
1 1/2"	38	306.0	38.1	110.0
2"	51	406.0	50.8	110.0
2 1/2"	63	503.0	63.5	127.0
3"	76	561.0	76.2	148.0
3 1/2"	89		89.0	
4"	102	662.0	101.6	178.0

卡箍式直通过滤器 Clamped straight strainer
|SMS|3A|IDF|ISO|3132008

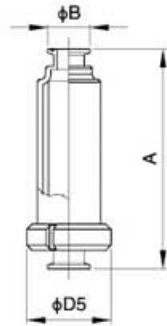

Size	A	B	D5	kg
1"	25	306.0	50.5	95.0
1 1/2"	32	306.0	50.5	110.0
1 1/4"	38	306.0	50.5	110.0
2"	51	406.0	64.0	110.0
2 1/2"	63	503.0	77.5	127.0
3"	76	561.0	91.0	148.0
4"	102	662.0	119.0	178.0

焊接角式过滤器 Welded angle-type strainer
|SMS|3A|IDF|ISO|3131009

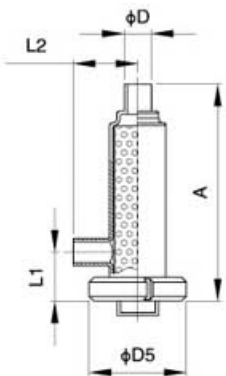

Size	A	D	D5	L1	L2	kg
1"	25	306.0	25.4	95.0	60.0	70.0
1 1/4"	32	306.0	32.0	110.0	60.0	70.0
1 1/2"	38	306.0	38.1	110.0	80.0	70.0
2"	51	406.0	50.8	110.0	100.0	72.0
2 1/2"	63	503.0	63.5	127.0	120.0	85.0
3"	76	561.0	76.2	148.0	140.0	96.0
3 1/2"	89					
4"	102	662.0	101.6	178.0	160.0	117.0

卫生级呼吸器/地漏系列
Sanitary Rebreather Floor Drain Series

卫生呼吸器 Sanitary rebreather
|3132010

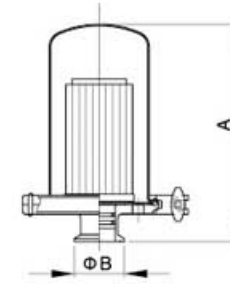

Size	A	B	kg
1"	180.0	50.5	
1.5"	180.0	50.5	
2"	180.0	64.0	

地漏 Floor drain
|3130011

排水口有活动式/固定式 There are types of the scupper,moveable and fixed one

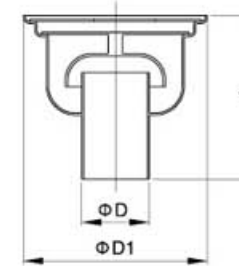

Size	A	D1	D	kg
1"	80.0	130.0	25.0	
1.5"	80.0	130.0	38.0	
2"	100.0	195.0	51.0	
2.5"	100.0	195.0	63.0	
3"	130.0	230.0	76.0	
4"	130.0	230.0	100.0	